

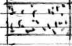





SIGNATURER:

-  ① ASFALT FJERNES - GRÆSTILSÅS
-  ② 2 TRÆER FJERNES
-  ③ HÆK FJERNES
-  ④ CYKELSTATIVER VED BUSSTOP
-  ⑤ BÆNKE
-  ⑥ OPLÆSELIG STELE
-  ⑦ GRANITSTELER PR. 1,5 M
-  EKSISTERENDE HÆKKE
-  ⑧ FLYTTET INFO-TAVLE
-  TILKØRSEL TIL STADEPLADSER
-  EKSISTERENDE TRÆER
-  TOILETBYGNING

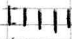
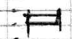
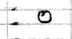
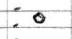
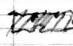

DRAGØR KOMMUNE
Plan og Teknik

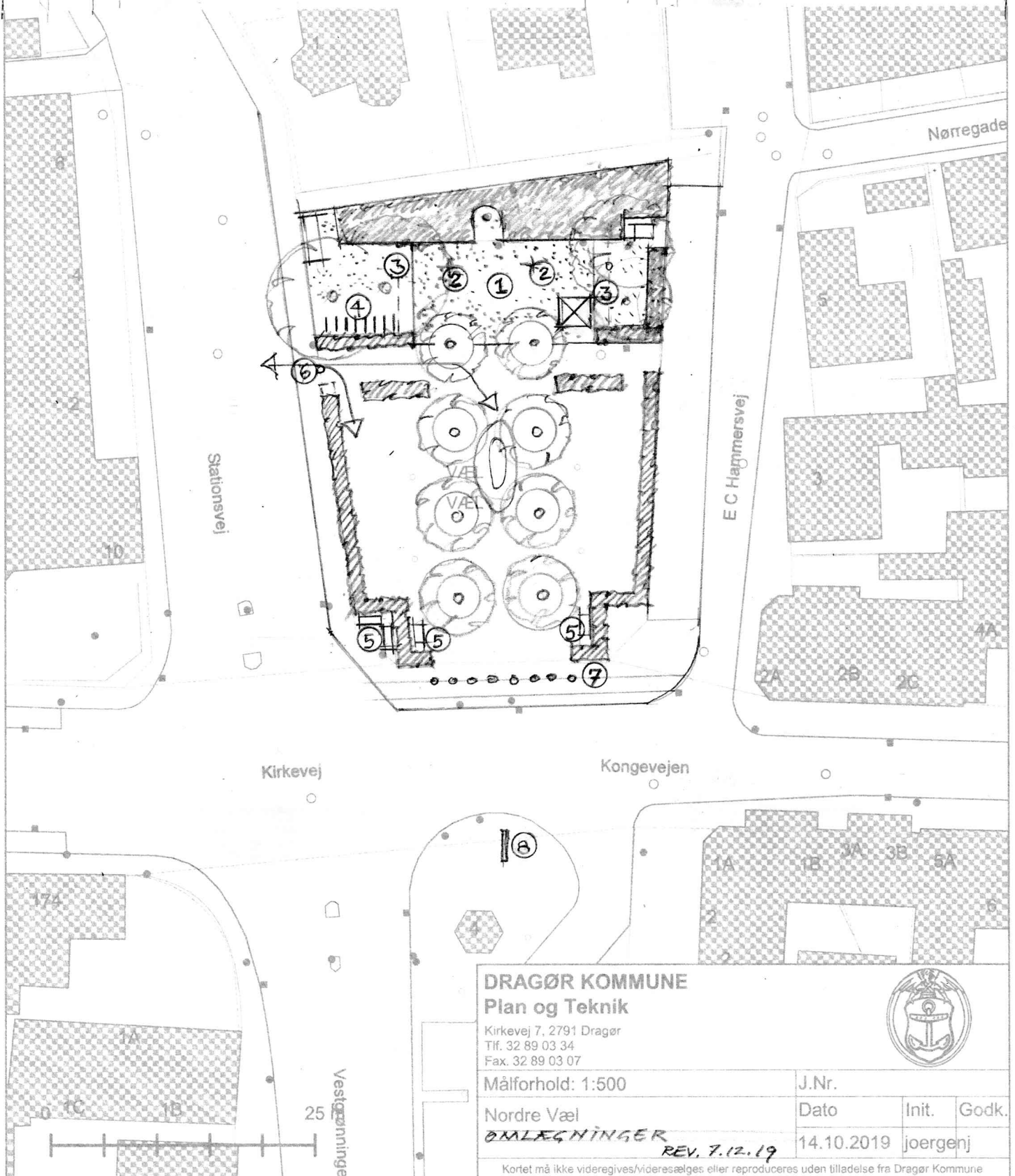
Kirkevej 7, 2791 Dragør
 Tlf. 32 89 03 34
 Fax. 32 89 03 07



Målforshold: 1:500

J.Nr.

Nordre Væl
OMLÆGNINGER
 REV. 7.12.19

Dato

Init.

Godk.







14.10.2019

joergenj

Kortet må ikke videregives/vidersælges eller reproduceres uden tilladelse fra Dragør Kommune

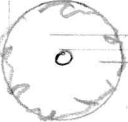
OMLÆGNING . VED NORDRE VÆL

NOV. 2019. TJ
REV. 7.12.2019

-  EKS. LIGUSTERHÆKKE
-  NYE BRØGEHÆKKE / BRØGEPUR
-  EKS. TRÆ DER BEVARES
-  EKS. TRÆ DER FJERNES
-  OPLÆSELIG STELE
-  GRANITSTELER

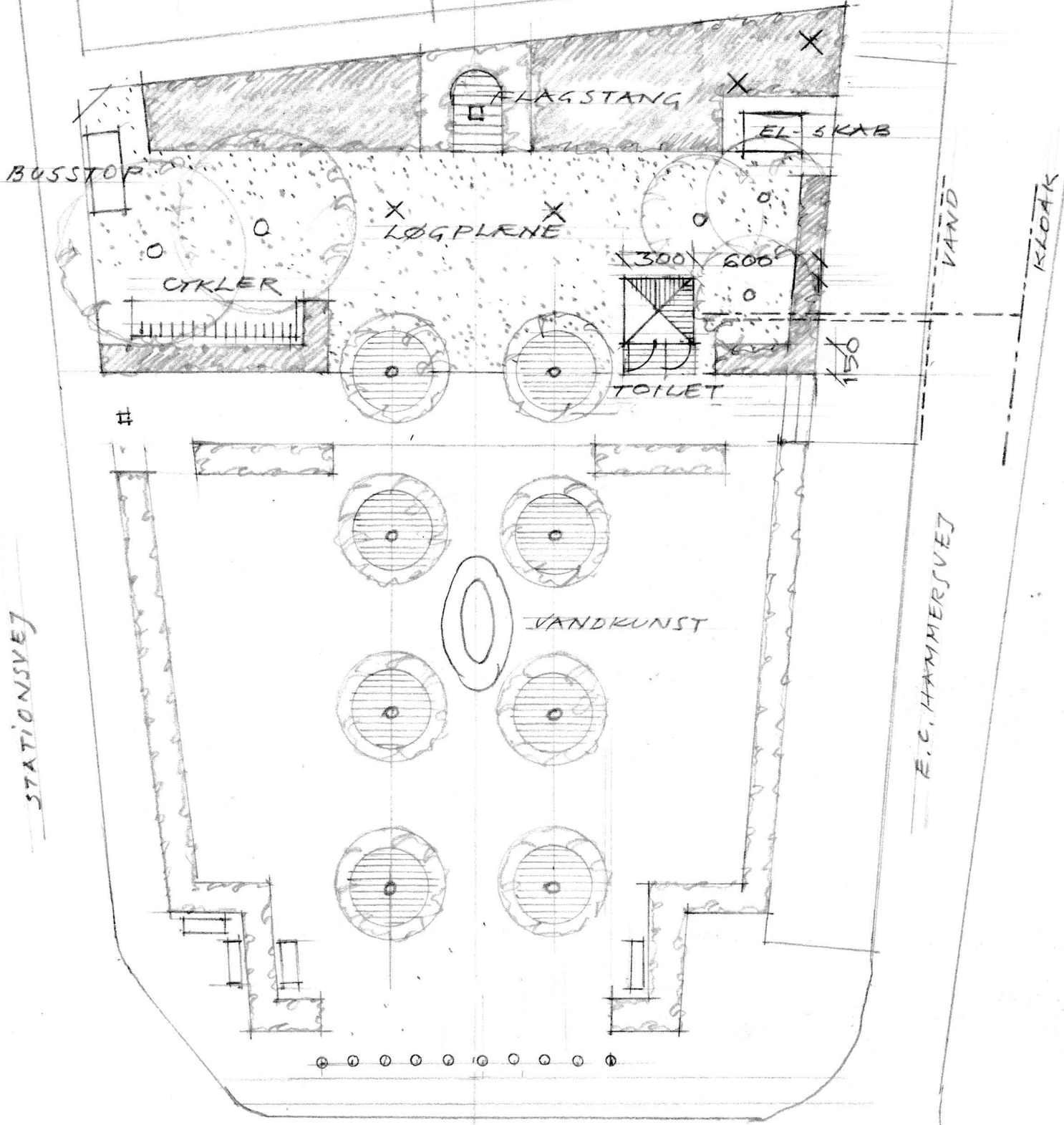

PLAN 1:250

KONGEVEJEN